

Los Angeles International Airport — Inline Baggage Screening System

Los Angeles, CA

Client

The Los Angeles World Airports

Value

US\$100,000,000

Completion

2009

Assignment

Construction Management

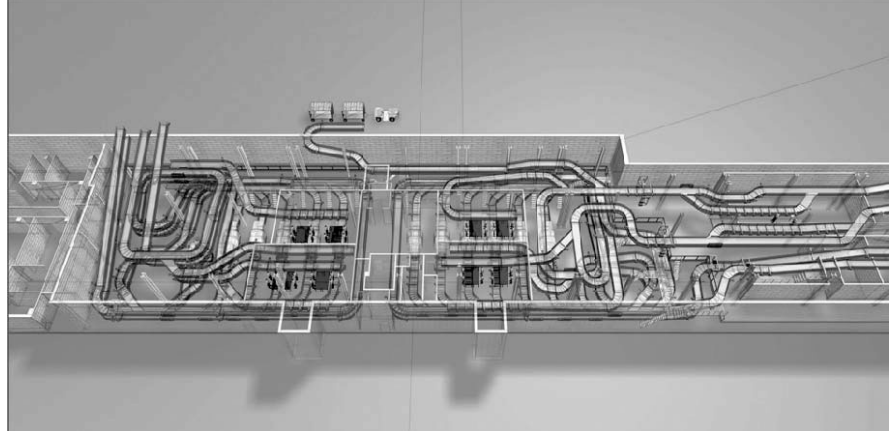

Bovis Lend Lease, in conjunction with PBS&J, managed the Inline Baggage Screening System at Terminals 1 through 3 at Los Angeles International Airport.

The project replaced/modified the existing outbound baggage handling system with a new inline, outbound baggage handling system, which integrates with the new explosion detection systems equipment.

The total (US\$256,467,000) program will include the completion of terminals one through eight at LAX and terminals 2 and 4 at Ontario International Airport.

The project work scope included the construction of and/or relocation of various facilities including baggage screening rooms, electrical rooms, mechanical rooms, information technology rooms and tenant offices, and various utilities including water lines, sewer lines, storm drains, security systems and fire life safety systems. New infrastructure for a central information technology network, and local and centralized TSA control rooms were also constructed.

The work scope also included extensive, phased development and staged integration of multiple existing and new baggage conveyance systems, and monitoring and control systems.

The project team was responsible for the manufacturing, delivering, fabrication,

design/engineering, warranty, inspection, maintenance, field survey, installation, coordination, testing and commissioning all interfaces with systems, which interconnect with the new and/or existing baggage handling equipment and other associated systems including:

- Fire Alarm and Notification Systems
- Access Control Alarm Monitoring System (ACAMS)
- Closed Circuit Surveillance Television (CCTV)
- Baggage Handling System (BHS)
- Building Maintenance Systems (BMS)
- Flight Information Display Systems (FIDS)
- Airline Baggage Reconciliation System (BRS)
- Baggage Information Display System (BIDS)
- Explosion Detection Systems (EDS)
- Telecommunications Systems
- Common Use Systems
- Law Enforcement
- Government Agency Systems, and
- Airline Reservations

The systems report to multiple command centers, node centers and control locations.